

To be used in hazardous areas

MSM has a wide range of NCCP with ATEX, IECEx, ERC, INMETRO and Chinese Certificate of Conformity classification. These enclosures are suitable to be used in hazardous areas for different applications, such as push-button stations, instrument housing, lighting distribution panels, power distribution panels, etc.

FEATURES

- Classification:
GROUP II: Equipment on surface (no mining)
ZONE 1/2: Category 2 & 3
ZONE 21/22: Category 2 & 3
ATMOSPHERE: GAS and DUST
- The NCCP are available in aluminium or stainless steel 316L (under request).
- Internal main Photocell and Sync module as an option.
- IP 66 watertightness degree.
- Manual On/Off + Automatic Selector for Nav aids system.
- Terminals and protections for power supply and outputs.
- Reverse-polarity, over voltage and short-circuit protections.
- Power distribution to the Nav aids systems.
- Internal anti-condensation painting.
- Optional stainless steel frame.



At MSM Offshore we design our own control panels, we adapt to the requirements of the client and the project, for this reason we have different sizes and configurations.

We have control panels for all types of systems, from simple systems, such as a main lantern, to more complex systems where we include a whole system of visual and audible aids.

The NCCP-Ex have been specially designed for use in potentially hazardous areas, where flammable liquids, gases or vapours are present (Zone 1, Zone 2, Zone 21 and Zone 22).

Designed according to IALA Recommendation.

GAS: II 2GD Ex db IIB+H2 T6/T5/T4 Gb

DUST: II 2GD Ex tb IIIC T85°C / T100°C / T135°C Db IP66

Materials and environment

Temperature range:	From -50° to +60°C.
Enclosure material:	Aluminium or Stainless steel AISI 316L.
Watertightness degree:	IP 66.
ATEX cable glands:	M20 to M32

NCCP-EX

Electronic devices

Control Panel

! Specifications subject to change without previous notice.

Stainless steel dimensions

TYPE	External Dimensions			Fixing Holes		Fixing Bolts	Weight Kg
	Height (H)	Width (W)	Depth (D)	T	U	ØZ	
NCCP-SA-EX	320	255	182	175	258	M10	32
NCCP-SB-EX	430	255	240	285	258	M10	42
NCCP-SC-EX	430	415	260	330	403	M10	80
NCCP-SD-EX	535	495	260	370	478	M10	99
NCCP-SE-EX	600	545	275	405	538	M16	144
NCCP-SF-EX	845	460	320	605	450	M16	180
NCCP-SG-EX	835	615	315	605	616	M16	281
NCCP-SH-EX	835	615	410	605	616	M16	309

*** All dimensions are in mm

Standards and Certifications

Gas: II 2G Ex db eb IIB T6 Gb

Dust: II 2GD Ex tb IIIC T85°C / T100°C / T135°C Db IP66.

Group II: Equipment in surface (no mining).

Zone 1, 2, 21 & 22: Category 2.

General requirements: EN 60079-0 / IEC 60079-0.

Equipment protection by Increased Safety: "i", EN 60079-11.

Equipment protection by Flameproof Enclosure: "db", EN 60079-1.

Equipment protection by Enclosure Protection: "tb", EN 60079-31.

Temperature Class: T6/T5/T4. T85°C / T100°C / T135°C.

Protection against Gas: (G) and Dust (D).

Certificates n°:

- INERIS 14ATEX0002X
- IECEx INE 14.0017X
- RU C-IT.AA87.B.00188
- LEC 15.0023 X
- CNEx17.1730X
- P431085 and P431059

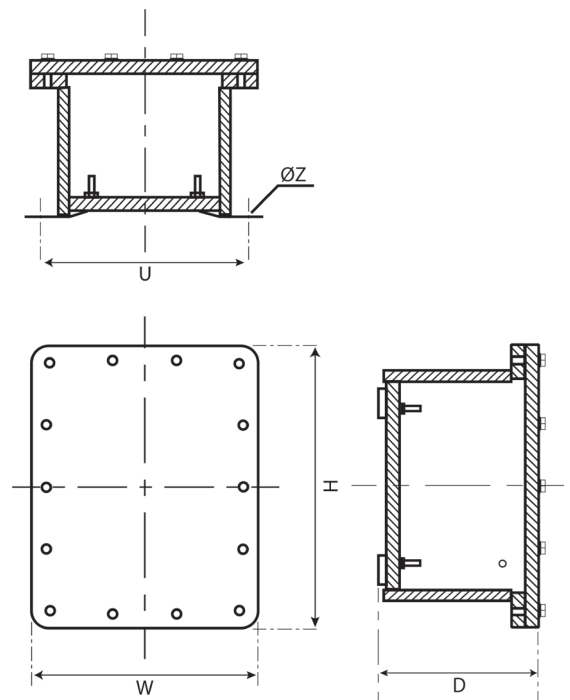

Options

Tempered glass window.



Mediterráneo Señales Marítimas, S.L.
34 96 276 10 22
offshore@msmoffshore.com
www.msmoffshore.com